



ADVENTURE KOMODO

Explore the Indonesian archipelago
in five-star luxury



No Boundaries



Go beyond the beaches and tourist havens and discover the spectacular beauty of Indonesia's marine environment in stylish comfort aboard Adventure Komodo.

Normally inaccessible to all but the most dedicated adventurers, this beautiful ocean playground consists of over 18,000 islands and spans more than 5,000 kilometres, roughly one eighth of the world's circumference, with unrivalled surf breaks, spectacular dive locations and great swathes of pristine marine environment.

Now, with the power, spacious living areas and ultra-modern facilities of a twin hull 75 foot catamaran at your disposal, these hard to reach areas are yours to enjoy at leisure. Cruising in comfort at speeds of up to 15 knots overnight, the days are free to explore and play in unspoiled areas beyond the reach of most visitors to the region.

With a top speed of 20 knots and a crew of six, Adventure Komodo has a range of more than 1,500 nautical miles from its base in Bali and can remain at sea for up to two weeks. Built to the highest safety standards and commissioned in 2003, Adventure Komodo is a spacious, fully air-conditioned vessel designed specifically for blue water cruising in style and luxury.

And with comfortable twin and double cabins for up to 12 guests, fantastic cuisine prepared by a trained Cordon Bleu chef, a full audio-visual entertainment system and the facilities you would expect from a five star dive resort, the opportunities for exploring Indonesia's ocean habitat are endless.



INDONESIA



Uncharted Adventure

Cruise to Padang in western Sumatra to surf the mighty Mentawais or to Sorong in Papua in search of the elusive Birds of Paradise. See the Komodo Dragon in its natural habitat or dive the unspoiled reefs of Flores, Adventure Komodo brings all of Indonesia's spectacular archipelago within your reach.

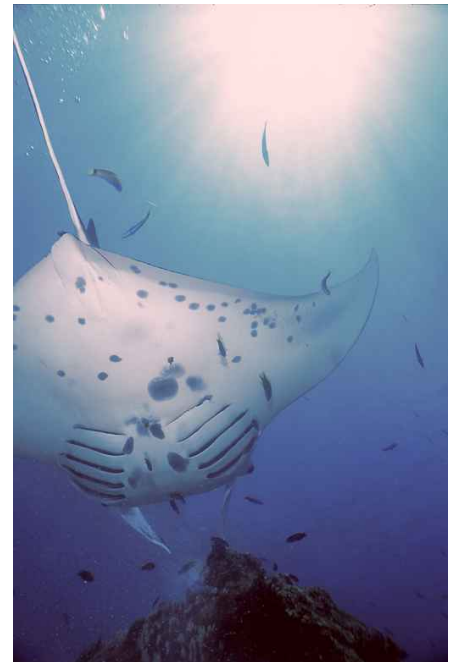

Diving for fun or logging up to five underwater photo shoots a day, the Adventure Komodo has the equipment and facilities to satisfy even the most committed dive professionals.

Surfing is a breeze due to the long range and advanced navigation equipment aboard the Adventure Komodo and gives you the choice of visiting Indonesia's many spectacular offshore breaks or discovering your own secret spots.

Two 4.5 meter tenders with 40hp outboard engines provide support for multiple dive sites and the vessel holds sufficient tanks and weight belts for up to 20 divers. Twin Shifflauer dive compressors offer a choice of Nitrox or standard air for maximum flexibility.



Specifications

Adventure Komodo 75' Catamaran

Accommodations

- All Fully Air-conditioned
- 1 x two berth cabin aft in hull with port hole
- 3 x double berth in hull with port hole
- 2 x two berth cabins with desk in cabin main deck with full view windows
- Crew have three separate cabins

Heads

- One head with shower in each hull
Toilets are fresh water to eliminate odour
- One head on back deck services two main deck cabins and day use for back deck
- Crew have separate head and shower
- Two showers on marlin platforms aft

Saloon

- Two wrap around sofas with tables each one seating 5 people
- Dining area and table for 10 persons
- Saloon has full view of gourmet galley

Entertainment Located in Saloon

- 29" TV flat screen system
- DVD/ Video CD
- CD player
- X-BOX
- A selection of music and video disks are on board and guests are encouraged to bring personal selections

All above piped through Sony amp and surround sound speakers

Electronics Located on Bridge

- SSB Icom radio with hF radio modem/ e-mail
- 36nm radar
- GPS with c-map
- Color sounder, fishing type
- Back-up digital depth sounder
- VHF
- Satellite phone with fax (Inmarsat mini-m) @ \$5 per minute international or local
- Indonesian satellite phone (local system) @ \$3 per minute local calls only
- Digital back-up GPS unit
- Auto helm
- Steer by wire (i.e. no steering wheel only joy stick)
- Various engine monitoring instruments and various other critical element controls/alarms

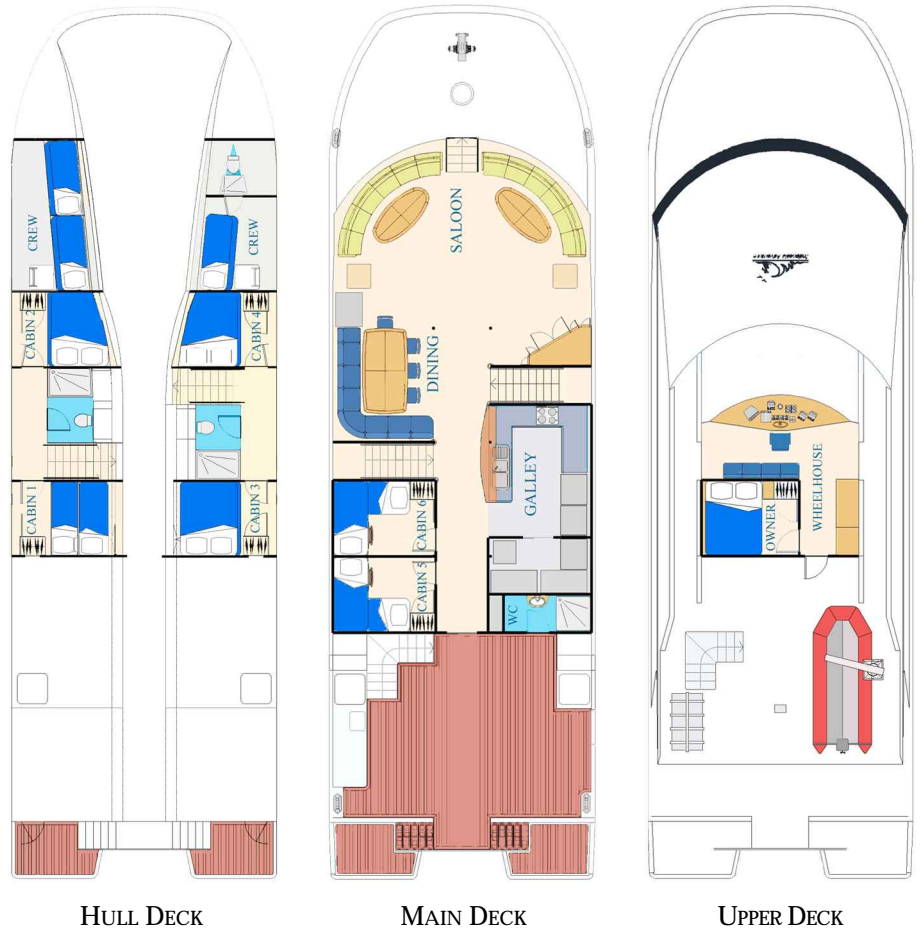

HULL DECK

MAIN DECK

UPPER DECK

Engineering Areas

- 430 hp Twin Cummins which are light-weight and deliver high power.
- Cruise speed of 15 knots and top speed of 20 knots however most long distance passages and night time cruising will be at 8 – 10 knots for safety
- 3500 liter/day water maker
- 2 x 40kva generators. 3 phase
- 8,000 liters of fuel giving 1,500 nm range at 12 knots
- 1 x Shifflauer dive compressor (air only) filling 10 cylinders per hour
- 1 x Shifflauer dive compressor connected to nitrox membrane system filling 8 tanks per hour
- Oxygen generator for emergency requirements

Aft Deck

- 1 x head with shower
- BBQ
- Sink and table for fish cleaning
- 6 x relax game outriggers & pole holders
- Fighting chair
- 2 x Transom showers

SAFETY

- EPIERB
- Life vests for 18 people
- 25 person life raft
- Designed to DNV rules and regulation for high speed and light craft under the inspection authority of USL class 2B surveyed Western Australia*

Marine Safety

- Comprehensive First Aid kit and oxygen generator as mentioned

Accessories

- 2 x 4.5 meter (15') tenders with folding tops and 40 hp outboard engines
- Dive cylinders and weight belts for 20 divers



ADVENTURE H₂O

P.O. Box 3824, Denpasar 80023
Bali, Indonesia
Telephone: (62) 812 465 2725
inquiry@indonesiaadventure.com
http://www.adventureh2o.com